

## WETROOMS® KlicKerfloor® LVCT™ GUARANTEE

- The 15 year domestic product guarantee is valid only when Wetrooms® KlicKerfloor® LVCT™ is installed in a residential location in accordance with the installation guidelines. We hope you will enjoy your KlicKerfloor® LVCT™ flooring by Wetrooms® for many years to come.
- Proof of purchase must be retained for all claims.
- The guarantee is not transferrable.
- This KlicKerfloor® LVCT™; Luxury Vinyl-Click Tile flooring by Wetrooms® is guaranteed for 15 years against staining, and wearing through when fitted in standard domestic situations, and for 6 years when fitted in light commercial office and similar situations.
- This guarantee applies only to the original purchaser, and proof of purchase must be retained for all claims.
- The guarantee covers the replacement or refund of the product, but does not include the labour involved.
- Chips and scratches are not covered by the guarantee. Vinyl may chip or scratch if a sharp object is dropped on it or dragged across it.
- Bridging and peaking may occur if insufficient expansion space has been provided. Claims for these problems will not be considered. A minimum of 1/4 inch expansion gap is recommended.
- Claims for wear must show a minimum ½ inch diameter area.
- This guarantee is pro-rata based on the amount of time the floor has been installed. For example, if you have a claim after 6 years of your 15 year domestic guarantee, we would refund or replace 60% of the floor value (6 years since purchase is 40% of the 15 years guarantee period).
- Wetrooms® KlicKerfloor® LVCT™ must be installed and maintained as advised in the Installation Instructions and Maintenance Guide below in each pack of flooring.
- Maintenance instructions are to be found in each pack of flooring, or contact your retailer, or Email:- info@wetroomsintl.com.

## WETROOMS® KlicKerfloor® MAINTENANCE GUIDE

- You have just installed KlicKerfloor® LVCT™ Luxury Vinyl-Click Tiles from WETROOMS®. Your new resilient floor was produced to the highest quality of standards and will provide you with years of enjoyment. Although WETROOMS® KlicKerfloor® LVCT™ is one of the easiest floors to maintain, please follow the recommendations in this guide to retain the product's fresh look and to protect the factory surface finish.
- After installing the floor, we recommend a first cleaning to remove any loose dirt or debris that may have been introduced during the installation process. First, sweep and vacuum the floor surface to ensure removal of all loose dust, dirt, and debris.
- Frequently moved furniture (chairs) should be equipped with felt pads to avoid scratching the floor and checked regularly. Heavy furniture and appliances should be equipped with non-staining large surface floor protectors.
- Furniture with castors or wheels must be easy swiveling, large surface non-staining and suitable for resilient floors. Do not use ball type castors as they can damage the floor.
- Avoid exposure to long periods of direct sunlight. Close blinds or drapes during peak sunlight hours
- Use walk-off mats at entrances to prevent dirt and grit from being tracked on to the floor.
- Sweep or vacuum the floor regularly to remove loose dirt. Avoid using a vacuum with a beater bar.
- Clean up spills immediately.
- Damp mop as needed using clean water and a diluted floor cleaner. Do not use harsh cleaners or chemicals on the floor, WETROOMS® KlicKerfloor® vinyl floor cleaner may be used as recommended on the label.
- Check any new cleaning agents on a small test patch of the floor in an inconspicuous area, and never use harsh cleaners such as alcohol ammonia-based cleaning products, or cleaners containing bleach.
- Do not use polish or wax.
- Do not subject the floor to excessive temperatures that may damage the floor. Long-term continuous room temperatures over 35 degrees centigrade (95 degrees Fahrenheit) combined with strong direct sunlight will damage your WETROOMS® KlicKerfloor® LVCT™ floor.
- To avoid an uneven appearance, relocate area rugs from time to time. Ventilation or intermittent air conditioning in vacant homes is recommended.
- Do not allow pets with unclipped nails to damage your WETROOMS® KlicKerfloor® LVCT™ floor. This may result in severe scratching.
- Do not allow high heeled shoes that are not protected with proper tips on the heels to damage / scratch your WETROOMS® KlicKerfloor® LVCT™ floor.
- If your floor has been exposed to excessive amounts of water due to flooding, do not panic, WETROOMS® KlicKerfloor® LVCT™ flooring is waterproof! Simply remove the water as quickly as possible. A dehumidifier should be installed in the room.

## INSTALLATION GUIDE



Tel: 0141 641 0478  
Email: info@wetroomsintl.com www.wetroomsintl.com

## EASY TO INSTALL – NO GLUE NEEDED

**PRE-INSTALLATION INSPECTION:** It is the duty of the person installing the floor to inspect all flooring before installation. If during inspection the installer or buyer feels the floor is the wrong color, improperly manufactured, is off-grade or is the wrong gloss level, he/she should NOT install the flooring. Please immediately contact the retailer from which the flooring was purchased. No claims will be accepted for flooring which is visibly wrong if such flooring is installed. Installed flooring is deemed to be visibly acceptable.

## INSTALLERS PLEASE READ PRIOR TO INSTALLATION THEN PASS THE MAINTENANCE INSTRUCTIONS TO THE END USER (page4)

Wetrooms® KlicKerfloor® Luxury Vinyl-Click Tiles (LVCT™), is the newest generation of high-quality resilient luxury vinyl flooring, with a strong WPC (wood plastic composite) base core, ensuring a strong watertight valinge click joint. It can be installed in a fraction of time of ceramic tiles or traditional luxury glue-down vinyl tiles, or wooden floors.

Wetrooms® KlicKerfloor® LVCT™ resilient vinyl flooring is warm-to-the-touch, and more sound absorbing than wood, laminate, and ceramic tile flooring.

Wetrooms® KlicKerfloor® LVCT™ has a unique valinge interlocking edge design for easy installation. No Glue is required – the floor is fitted as a floating floor. Simply follow the steps and you will experience how easily this product is installed in just a few hours.

Wetrooms® KlicKerfloor® LVCT™ wear layer has millions of ceramic microspheres that makes KlicKerfloor® flooring a more durable and resistant flooring option.

Wetrooms® KlicKerfloor® LVCT™ can be easily disassembled and re-assembled.

### PREPARATION

#### Tools and materials needed:-

- Utility knife & straight edge
- Saw
- Measuring tape
- Shears for cutting around irregular shaped objects
- 1/4 inch spacers
- Transition moldings and baseboards
- Tapping block, Pull bar

#### Hints for measuring

- Measure the length and width to determine the square footage of the room. Alcoves or offsets should be measured separately. Purchase at least 10% extra to cover waste, trimming and for future replacement needs.
- Note: If you have more than one run number, we recommend you install planks from 4 or 5 different packs from different run numbers together. This will limit shade variations.
- No underlay is required for Wetrooms® KlicKerfloor® WPC base core LVCT™ flooring.
- LVCT™ rigid flooring with special WPC (wood plastic composite) rigid waterproof base core, may be installed over a foam or suitable underlay, which will assist for additional sound-proofing.

CAUTION: Do not install Wetrooms® KlicKerfloor® LVCT™ over carpet. This product is not suitable for outdoor use, or rooms that may be exposed to flooding. We also highly recommend you do not install Wetrooms® KlicKerfloor® LVCT™ in rooms or homes in which the temperature is not controlled. Exposure to long term direct sunlight and temperatures in excess of 35 degrees centigrade (95 degrees Fahrenheit) can cause expansion damage to your floor. We strive to maintain strict quality control during the manufacturing process but we recommend checking all planks to prior to installation.

## GENERAL INFORMATION FOR INSTALLERS

KlicKerfloor LVCT™ features the patented Valinge 2G interlocking planks for easy installation and is installed as a glueless floating floor. The interlocking planks lock together to provide a tight water resistant seam, can be installed over most floor surfaces, and is suitable for both residential and light commercial interior applications. For technical information or questions, you can email: info@wetroomsintl.com

#### General Information:

1. Flooring should be transported and stored in a neatly stacked fashion on a smooth flat surface.
2. Acclimatise the flooring and the rooms to be installed at a constant temperature between 65° and 85°F (18.33° and 29.44°C) for 48 hours before, during, and maintained after installation.
3. LVCT should only be installed after other trades have finished and the jobsite has been cleaned and cleared of debris that could potentially damage a finished plank installation.
4. Inspect flooring for damage, defects, or shading issues before installation; claims for visual defects will not be accepted after cutting and/or installed.
5. Mix and install planks from several different cartons during installation to ensure a random appearance.
6. Leave 1/4 inch (6.35mm) for expansion around the entire perimeter of the flooring.
7. Flooring should be protected from direct exposure to sunlight.



#### Subfloors General:

Planks can be installed over a variety of subfloor surfaces including concrete on all grade levels, wood and many existing hard surface floors. The subfloors must be clean, smooth, flat, solid (no movement), and dry. **Do not install planks over floors that are sloped for drainage.** Any uneven areas greater than 3/16 inch (4.76mm) in a 10 foot (3.05m) radius should be leveled with a Portland cement based patching compound. Vinyl tiles are resistant to water damage but they do not prevent the transmission of moisture. Care should be taken to keep moisture from collecting on either side of the vinyl floor to prevent the growth of unhealthy mold and mildew.

#### Concrete Subfloors:

Planks can be installed over concrete on all grade levels if a proper moisture barrier is used. A minimum 6 mil polyethylene moisture barrier must be used with concrete subfloors. Moisture vapor emissions should not exceed 5 lbs./24 hour per 1,000 sq. when tested with the Anhydrous Calcium Chloride Test in accordance with ASTM F 1869 or 80% RH in accordance with ASTM F 2170 "Standard Test Method for Determining Relative Humidity in Concrete Slabs using in situ Probes. Any uneven areas greater than 3/16 inch (4.76mm) in a 10 foot (3.05m) radius should be leveled with a Portland cement based patching compound. Holes and cracks in the cement should be patched, and expansion joints should be filled with a latex patching compound. Newly poured concrete floors must cure for a minimum of 90 days. Please note it is the person installing the floor and/or the homeowner's responsibility to ensure any moisture or alkalinity issues are resolved prior to installing the floor.

**NOTE: Excessive moisture may cause the growth of unhealthy mold or mildew and/or cause staining of the flooring which is not covered by our Warranty.**

#### Wood Subfloors:

Planks can be installed over a smooth, flat, level wood subfloor, underlayment grade plywood, lauan plywood and other underlayments recommended by the manufacturer for use with a vinyl plank floor. Subfloor should be flat within 3/16 inch (4.76mm) in a 10 foot (3.05m) radius. Wood subfloors must be suspended at least 18" above the ground. Adequate cross-ventilation must be provided, and the ground surface of the crawl space should be covered with a suitable vapor barrier.

**NOTE: Avoid subfloors with excessive vertical movement or deflection because subfloor movement will telegraph through to the finished installation. Indications of excessive deflection are subfloor fastener release, squeaking, compromised or sectional contours such as bowing or dipping in floors and uneven flooring material. Nail or screw subfloor panels to secure boards with excessive vertical movement or deflection prior to installation of the flooring material. Our warranties DO NOT cover any problems caused by inadequate substructures or improper installation of substructures.**

#### Existing Flooring:

LVCT planks can be installed over a variety of finished floors including single layer resilient sheet flooring/ tile, ceramic, marble and terrazzo. The surface must be in good condition and show no signs of excessive moisture conditions. Grout joints and heavy embossing (vinyl) in tile must be leveled so they are flush with the flooring surface. Additionally the tile may require several skim coats to achieve a flat surface. Carpet, heavily cushioned vinyl floors or vinyl floors consisting of multiple layers are NOT a suitable subfloor for installation.

#### Radiant Heat Subfloors:

KlicKerfloor LVCT planks can be installed over in-floor radiant heating systems provided the subfloor surface does not exceed 85°F (29.44°C) at any point. The initial floor temperature should not exceed 70°F (21.11°C) for 24 hours prior, during, and 48 hours after installation. Thereafter the temperature should be gradually increased to the desired setting up to 85°F (29.44°C). Radiant heating systems that are installed on top of the subfloor surface and covered with self-leveling underlayment are not recommend.

## LUXURY WPC VINYL-CLICK TILES INSTALLATION GUIDE

### Underfloor Heating Mats

Underfloor heating is possible with warm water heating systems. For other underfloor heating systems / mats check with the underfloor heating manufacturer. Before fitting, please confirm suitability and their guarantee. The temperature must not exceed 85°F (29.44°C) at any point.

### Important Notes:

1. Before removing any existing resilient flooring or tiles, please consult with a flooring professional to determine if asbestos abatement is necessary to avoid exposure. See current edition of the Resilient Floor Covering Institute (RFCI) publication "Recommended Work Practices for Removal of Resilient Floor Coverings" for detailed information and instructions on removing all resilient covered structures.
2. The products in this carton DO NOT contain asbestos or crystalline silica.
3. Remove wall base and undercut door jambs. Do not secure individual planks to the subfloor as it is designed to be a floating floor. Do not install cabinets on top of LVCT flooring.

### Pre-installation inspection:

It is the duty of the person installing the floor to inspect all flooring before installation. If during inspection the installer or buyer feels the floors is the wrong color, improperly manufactured, is off-grade or is the wrong gloss level, he/she should NOT install the flooring. Please immediately contact the retailer from which the flooring was purchased. No claims will be accepted for flooring which is visibly wrong if such flooring is installed. Installed flooring is deemed to be visibly acceptable.

## INSTALLATION GUIDE

1. First, determine how you want the flooring to run. Typically for plank products, the flooring runs the length of the room. There may be exceptions since it is all a matter of preference.
2. To avoid narrow plank widths or short plank lengths near the walls/doors, it is important to do some pre-planning. Using the width of the room, calculate how many full boards will fit into the area and how much space remains that will need to be covered by partial planks.
3. Start with a whole plank in the left hand corner of the room with the tongue side and end toward the wall. Lay the first row of planks along a chalk line and trim to fit to the wall allowing a 1/4 inch (6.35mm) expansion space. If starting the first row with a whole width plank it will be necessary to trim the tongues next to the wall, then place the cut ends next to the wall. To trim the planks, use a utility knife and a straight edge to score the top surface of the plank, and then bend it downward to separate the pieces.
4. The planks install easily without glue. Simply attach the tongue on one plank to the groove side on another plank and the planks will lock snugly together.



5. Begin installing the first row by laying a plank flat over the underlayment. With the tongue side facing the wall align the end of the second plank with the first and lock the end joints together by pushing it straight down on top of the first plank. Lock the ends of the planks together until the first row is finished. Cut the last board in the row to the necessary length. If the starting wall is out of square, it will be necessary to scribe the first row to match the wall, allowing the opposite side of the row to present a true square base for the rest of the floor. Then the first row is complete, you must have a straight, even base established. Ensure each plank of each subsequent row has a minimum 300mm overlap; that they are fitted brickwork style. This ensures a secure strong fit.

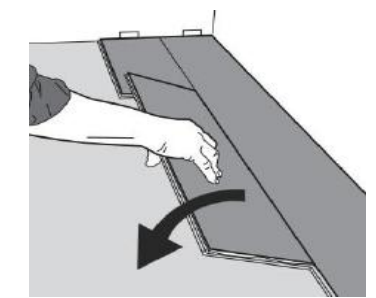
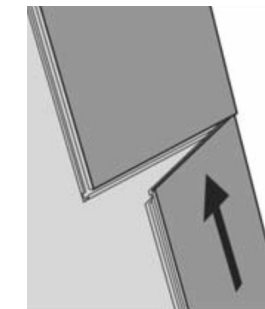
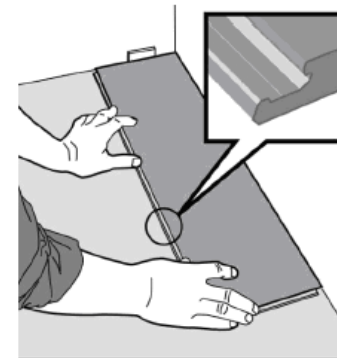

6. After installing the first row of planks, Line up the first plank of the second row so the outside end is even with the outside end of the first plank of the first row. Lock the long side of the second row plank onto the plank on the first row by inserting the tongue of the second plank into the groove on the first plank while holding the plank at a 45 degree angle from the floor. Press the second plank down flat and the tongue will lock firmly into place. After locking in place, lay the remaining planks in the row by first locking the long side in place and then tapping the end of the plank to slide firmly into place at its end. To install the rest of the flooring, continue placing the boards from left to right, plank by plank, and row by row.
7. LVCT planks are unique in that they can also be installed with a pull bar or tapping block and rubber mallet or hammer in difficult areas, such as the last row, and when fitting around door trim. Use a pull bar and rubber mallet or hammer to lock the joints together in the last row. Always use a pull bar on the cut edge of the plank. Factory edges can be damaged if the pull bar is used directly against them.
8. Bathrooms: When the LVCT planks are installed in a bathroom the flooring can be laid under the toilet only if the floor is separated from adjacent rooms with a doorway threshold. Otherwise the flooring should be installed around the toilet leaving a 1/8 inch (3.175mm) expansion space. Use 100% silicone caulking to fill the expansion space at the tub, shower and all wet areas to prevent surface water seepage under the floor.

### Finishing the Job:

Remove all spacers. Install wall trim lightly over the floor surface. Drive fasteners into the wall and not the floor. When installing doorway transition moldings allow a 1/4 inch (6.35mm) expansion space between the edge of the floor and under the molding. Do not drive fasteners in to the floor. Return appliances to the room by rolling or sliding over strips of hardboard to prevent damaging the floor.

## REPAIRS

In the unlikely event that a plank is damaged for whatever reason, the simplest method is to disconnect the planks carefully (protecting the tongue and groove edges) until the damaged plank can be removed. Then replace the damaged plank with a new one and re-assemble the disconnected planks. This typically works for planks that are close to the two long perimeters of a room. For damaged planks that are not close to the perimeter, you may have to remove the damaged planks and insert new pieces without the short and long end grooves.

1. Using a sharp utility knife and a straight edge, cut out the center of the damaged plank by leaving approximately 1 inch (25.4mm) strip attached to the adjacent planks.
2. Carefully cut back from the four corners of the plank to the inside edges in space left by the cut out plank. Remove the plank edges carefully from of the adjacent planks making sure the tongues and grooves of the adjacent planks are not damaged.
3. Using a sharp utility knife, remove the tongue strip on both the long and short ends of the replacement plank. In addition, remove the groove strip of the short end of the replacement plank.
4. Place two-sided carpet tape with one half under the sides of the adjacent planks where the tongues and the groove of the replacement plank have been removed. Only the top side release paper of the carpet tape should be removed. Leave the bottom side of the release paper in place, as it should NOT be taped to the subfloor.
5. Position the replacement plank by engaging the groove of the long side into the tongue of the adjoining plank and pushing down on the other three sides. The carpet tape will hold the replacement plank in place with its adjacent planks. Use a hand roller to further secure the tape.